

GARDEN DESIGN JOURNAL

MARCH 2022/ISSUE 234/£6

SGD SOCIETY OF
GARDEN
DESIGNERS®
Leading the way in excellence and innovation

THE JOURNAL OF THE SOCIETY OF GARDEN DESIGNERS®

BACK TO LIFE

- REUSE AND REPURPOSE IDEAS IN A SURREY SETTING
- LOCAL HISTORY INSPIRES A MODERN AUCKLAND GARDEN

SUSTAINABLE DESIGN
How to create a rainscape

LOW-POLLUTION LIGHTING
Key points for garden designers

FINDING A SENSE OF PLACE
The SGD's Autumn
Conference 2021, revisited

ISSN 1356-6458

MARCH 2022 £6



9 771356 645009

03 >

It is hoped that the show garden design will be used to create permanent gardens at EuroParcs' sites.

WHAT ARE YOU WORKING ON?

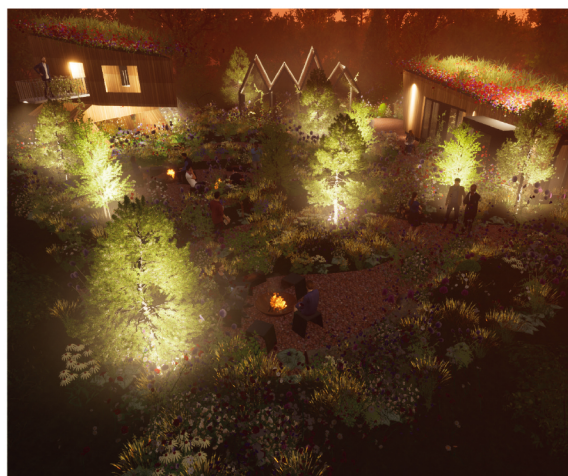

FLORIADE FLOURISH

Stefano Marinaz FSGD talks about his woodland-inspired show garden for Dutch expo, Floriade 2022

HAVING GAINED DEGREES in both Agronomy and Landscape Architecture, and an MA in Landscape Architecture, from the University of Greenwich in London, Stefano Marinaz MSGD then worked at the Royal Botanic Gardens, Kew, and for celebrated garden designer Arne Maynard before setting up his own practice in 2012. He is known for his contemporary designs and naturalistic planting, as well as for historical restorations and reconstructions of landscapes surrounding listed buildings. Stefano opened a new studio in Utrecht in the Netherlands in June 2021, to broaden the practice's scope in Europe, and he speaks to us here about a show garden he is creating for Floriade 2022, a Dutch expo that takes place once every 10 years and which showcases innovations in horticulture and garden design.

How did you secure the commission for a show garden at Floriade?

The commission actually came to us by chance. I had just set up our new studio in the Netherlands and was talking to a number of Dutch nurseries, when one of them was asked by EuroParcs – similar to Center Parcs in Britain – to recommend some designers who might create a show garden at Floriade. We were invited to put forward some design ideas and EuroParcs chose our concept, so we got the job.

What was the brief?

EuroParcs wanted to showcase the experience that its parks offer, so our design had to reflect the beautiful locations and the architecture of the holiday homes, while also reflecting the Floriade Expo's sustainability theme. The architects, OntheRoad Creatives, had selected two of the houses they had designed for EuroParcs' holiday sites to feature in the show garden – one traditional, the other more unconventional – and it was our job to incorporate them into a garden setting. The planting also has to perform across the seasons since the show is open from April to October.

What inspired your design?

We visited the client's holiday park in Apeldoorn, Holland, where EuroParcs also has its headquarters, and were inspired by the beautiful setting, a pine and birch forest. This gave me the idea for 400-600mm mounds planted with small trees, that would separate the houses, create an undulating landscape and offer the residents privacy. We also thought it would be great for holidaymakers to have the chance to grow their own food and pick fresh produce from the garden, ideas they could then try at home.

Tell us more about the show garden. Paths laid with peach, hazel and walnut

kernels will act as walkways through the landscape to informal seating areas and are separated by the mounds, which are planted with small conifers, ferns and perennials, including *Kirengeshoma palmata*, *Astrantia*, *Cimicifuga racemosa* and *Tricyrtis formosana*. The buildings will be clad with climbers such as evergreen jasmine and *Holboellia*, which are an easy-to-add layer of insulating foliage. There are some shaded spaces featuring larger trees, mosses and ferns, and more sunny areas where the grasses and flowering perennials such as *Echinacea pallida*, *Anthriscus sylvestris* 'Ravenswing' and *Asclepias tuberosa* will thrive. The design includes a glasshouse where people can sow seeds, and beds out in the garden that will be suitable for edibles such as tomatoes, courgettes and salads, which holidaymakers could harvest. The idea is that EuroParcs' maintenance teams would grow and maintain the produce if this concept is rolled out to real sites.

What have been the challenges?

Floriade Expo is planning to install an alphabetically organised encyclopaedia of plants and trees around the show site, and a section of it will be displayed within a four-metre strip right beside our plot. The plants will be different varieties of *Persicaria*, *Physocarpus* and *Prunus*. Visitors will walk through these to access our garden, and the challenge is to connect the list of plants chosen by the Floriade team with those in our planting scheme. This may mean we have to tweak the design a little, perhaps by adding a layer of *Deschampsia* or other grasses beneath the trees and shrubs. stefanomarinaz.com

Floriade 2022 takes place in Almere, in the Netherlands, from 14 April to 9 October 2022. floriade.com

DO YOU HAVE A PROJECT FOR GDJ?

Email: gdj@jamespembrokemedia.co.uk